

# HAL HOMES

Quality Homes with a Personal Touch®

[www.halhomes.com](http://www.halhomes.com)



## *The Tiffany II*

- *Two story foyer*
- *9' ceilings, first floor*
- *13' ceilings in study*
- *First floor master bedroom with sitting area*
- *Gourmet kitchen with granite counters and stainless steel appliances*
- *Sun room*
- *Large second floor bedrooms*
- *Three-car side entry garage*
- *3,935 square feet (approx.)*

Suite 401  
9545 Kenwood Road  
Cincinnati, OH 45242

513.683.4000 *model*  
513.984.5360 *corporate*  
513.984.1720 *fax*



In keeping with the policy of continued attention to design and construction details, we reserve the right to modify plans, designs, and specifications. This brochure is for illustration purposes and is not part of a legal contract.

11/1/2007



FIRST FLOOR

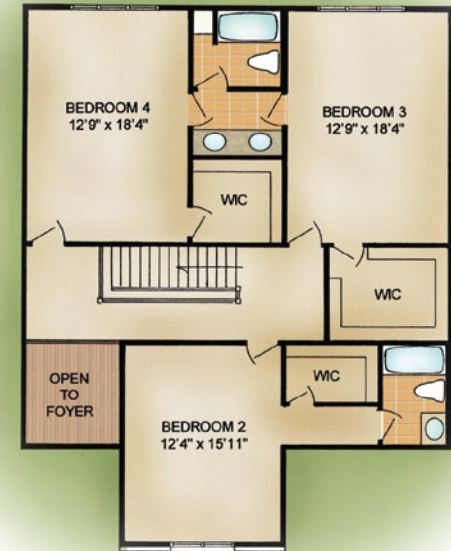

SECOND FLOOR



OPTIONAL LOWER LEVEL

In keeping with the policy of continued attention to design and construction details, we reserve the right to modify plans, designs, and specifications. This brochure is for illustration purposes and is not part of a legal contract.